



Arguably one of Jesmond's finest residential streets! A charming first floor apartment ideally located in the heart of Brandling Village Conservation Area on Burdon Terrace. Within walking distance to Newcastle City Centre, Burdon Terrace, a tree-lined avenue is perfectly placed close to the parade of shops on Clayton Road, Jesmond Metro Station and indeed the café culture of Jesmond.

Well presented throughout and boasting over 1,100 Sq ft, the accommodation briefly comprises: Entrance hall; and split level hallway; lounge, with stripped wood flooring; bedroom one measuring 15ft, with feature fireplace and stripped wood flooring; bedroom two; bathroom with four piece suite including roll top bath and step in shower cubicle; stylish kitchen diner with south facing sash windows, fully fitted with a range of wall and base units together with work surfaces and French doors leading out to the rear fire escape. Externally, the south facing rear communal gardens, laid mainly to lawn with mature planting, trees and fenced boundaries. With period features and gas central heating, this great apartment demands an early internal inspection!

First Floor Conversion Apartment | 1,103 Sq. ft (102.5m²) | Two Bedrooms | Lounge | Bathroom | Utility/WC | Stylish Kitchen Diner | Conservation Area | Well Presented with Period Features | South-Facing Communal Garden | Leasehold - Share of Freehold | Service Charge - £1,200 Per Annum | Council Tax Band D | EPC Rating: C

EPC - C

1ST FLOOR
1103 sq.ft. (102.5 sq.m.) approx.

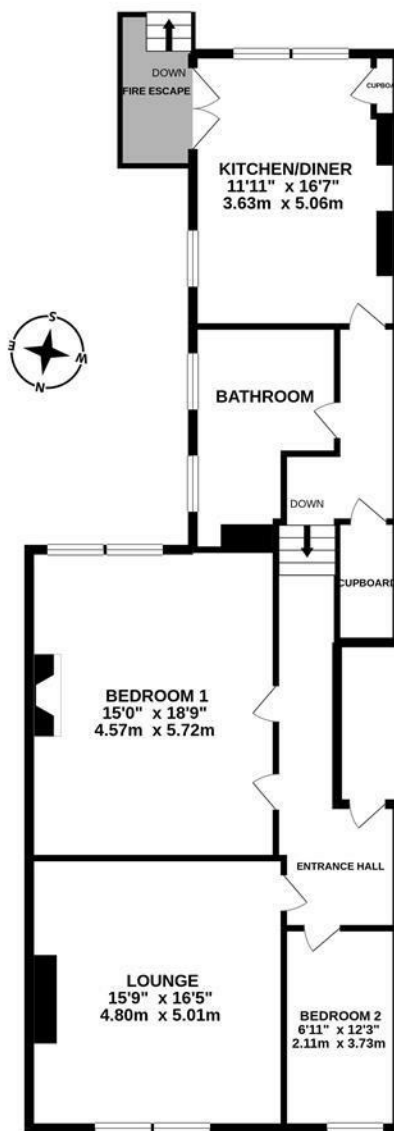

TOTAL FLOOR AREA : 1103 sq.ft. (102.5 sq.m.) approx.

Whilst every attempt has been made to ensure the accuracy of the floorplan contained here, measurements of doors, windows, rooms and any other items are approximate and no responsibility is taken for any error, omission or mis-statement. This plan is for illustrative purposes only and should be used as such by any prospective purchaser. The services, systems and appliances shown have not been tested and no guarantee as to their operability or efficiency can be given.
Made with Metropix ©2020



Offers Over £325,000

IMPORTANT NOTE: These particulars and the descriptions and measurements herein do not constitute representation and whilst every effort has been made to ensure accuracy, this cannot be guaranteed.

